

SI23(6907) IoT card connection guide

Note: SI23(6907) = software version of SI23 down 6907 (C00.28 = 6907)

1、 Need to download APP, IOT website: <http://gprs.veichi.com:8028>



VC.IOT

2、 wiring diagram

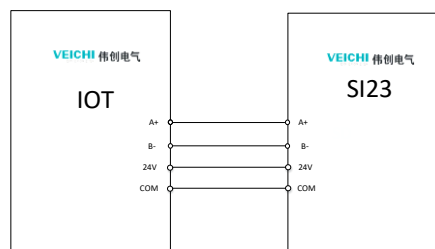

3、 Mobile APP login page in English and Chinese



Enter your account and password to log in. If it is in Chinese, click 我的 and change the 语言 to English.



4、 Click the search box to enter the search page and search the GPS code. The GPS code is on the nameplate, for example, my current GPS code 6020089. If the search does not work, please scan the QR code of the IoT card

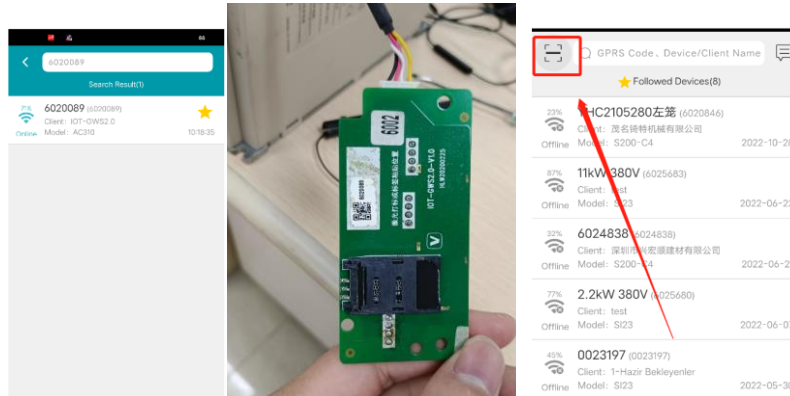

5、 confirm whether the light of the Internet of Things is a flash, if not, it means that it is not connected to, You need to set the local address of the inverter to 1, data format N-8-1, baud rate of 9600.

SI23(6907) parameters:

F13.01=1 F13.02=3 F13.03=0

6、 Change the monitoring model, click to confirm

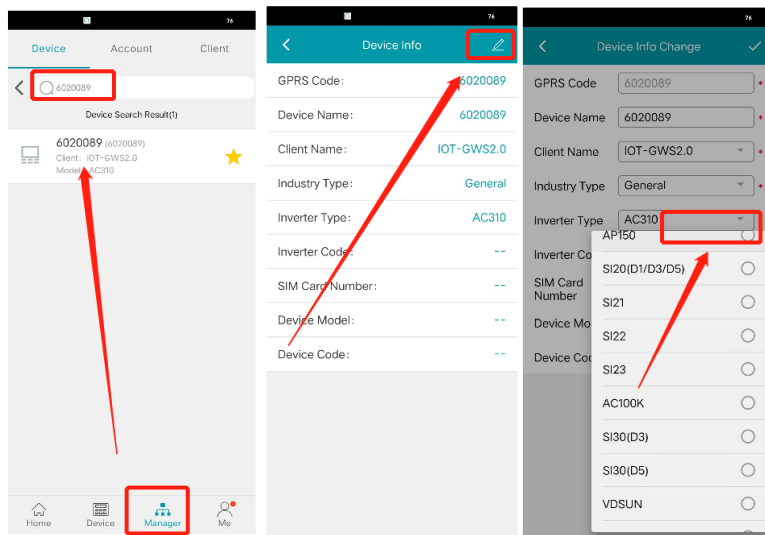

6、 Starting SI23, F00.02=2

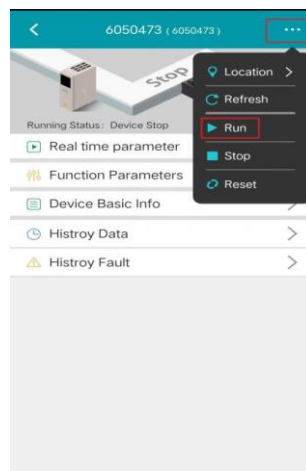

2G-IOT card connect WLAN function guidance

- 1、 Download WIFI application APP in your phone——VC.WIFI. If you use IPHONE ,please download and search the APP in your store.



1.1 Android QR Code

- 2、 Open already downloaded app, power on the IOT card. Click the search WIFI, connected your IOT number

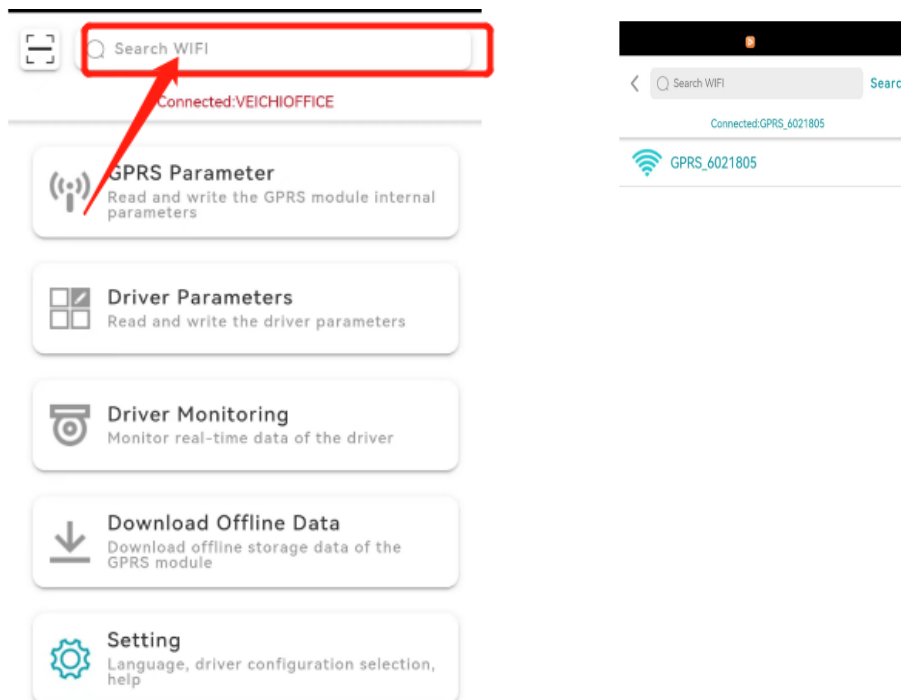

- 3、 Return to the main interface, then click GPRS parameter (only connect IOT WIFI to click) , enter and click the drop-down arrow to open the list.

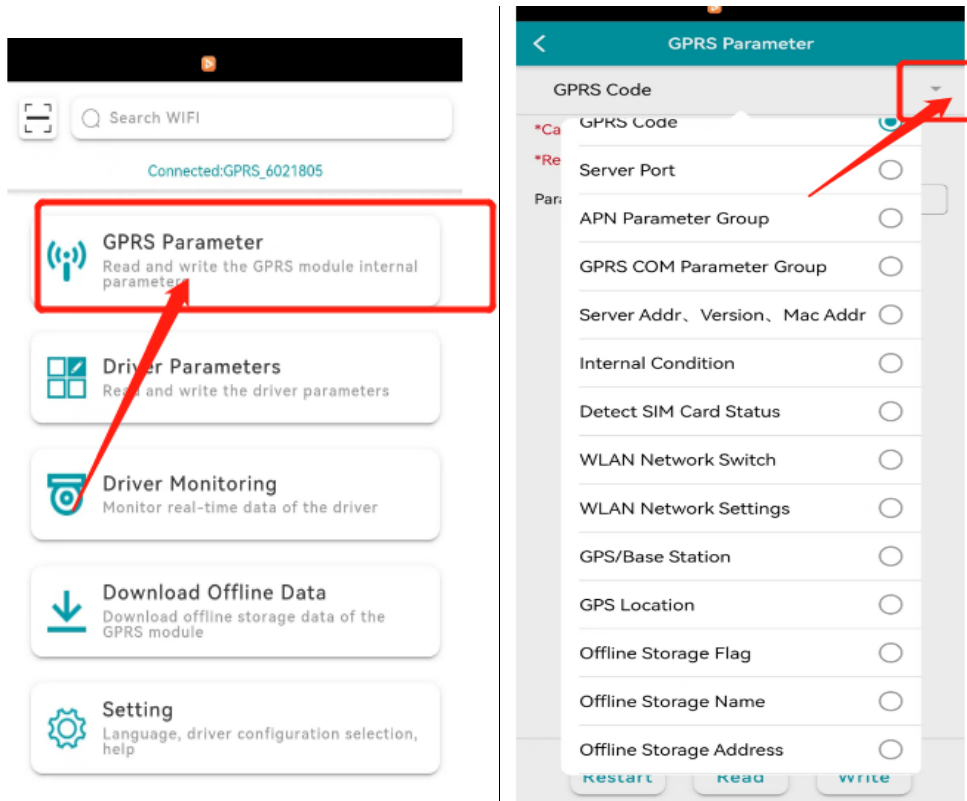

4、 Click “WLAN Network Switch”, open the function, and click “write “

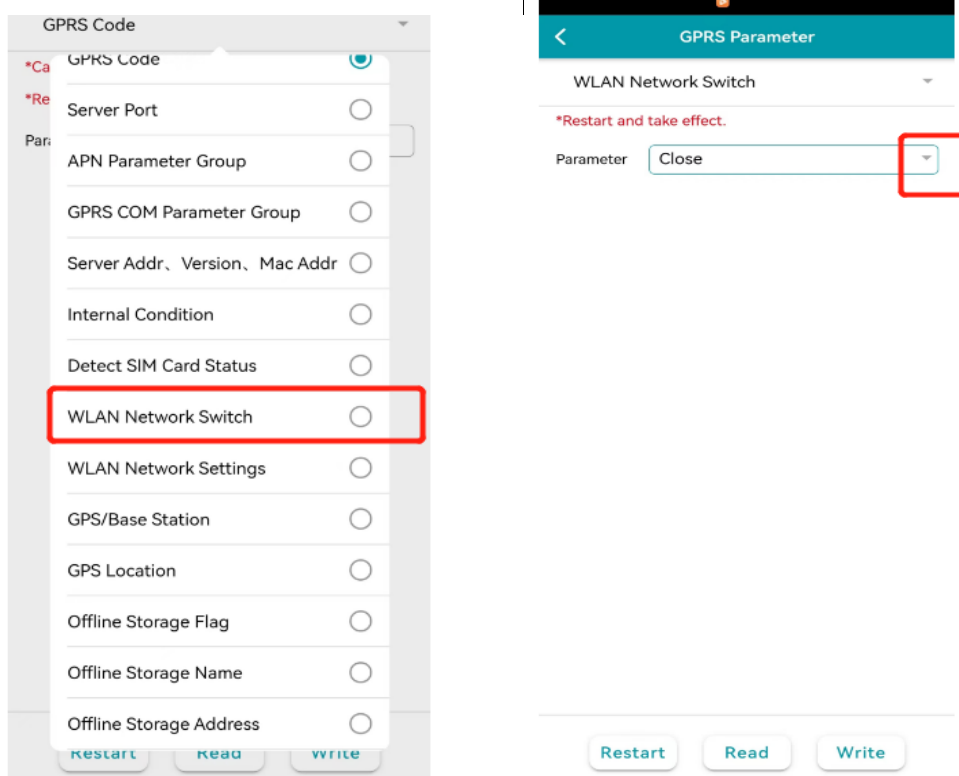



5、Click “WLAN Network Setting”, input your WIFI information (Must be accurate) , and click “write “, end to click “restart”

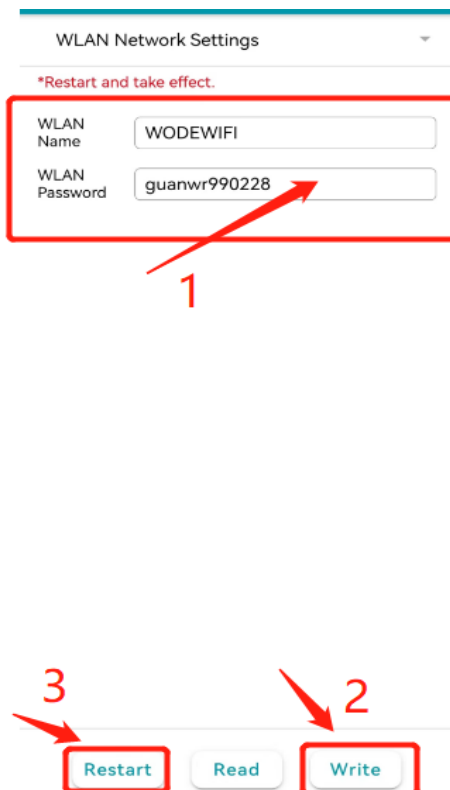
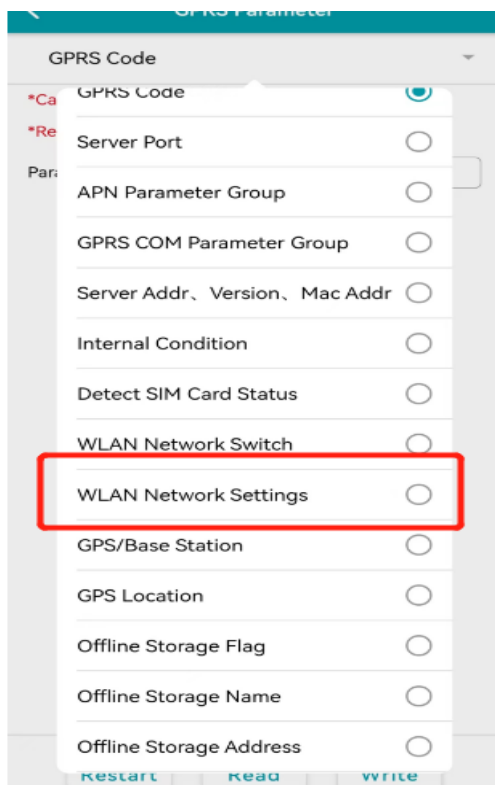

- 6、 Finally, in the WLAN can see the IOT device connection (WLAN band must be set 2.4HZ or can not connect). After that, you can connect to the IOT app normally.

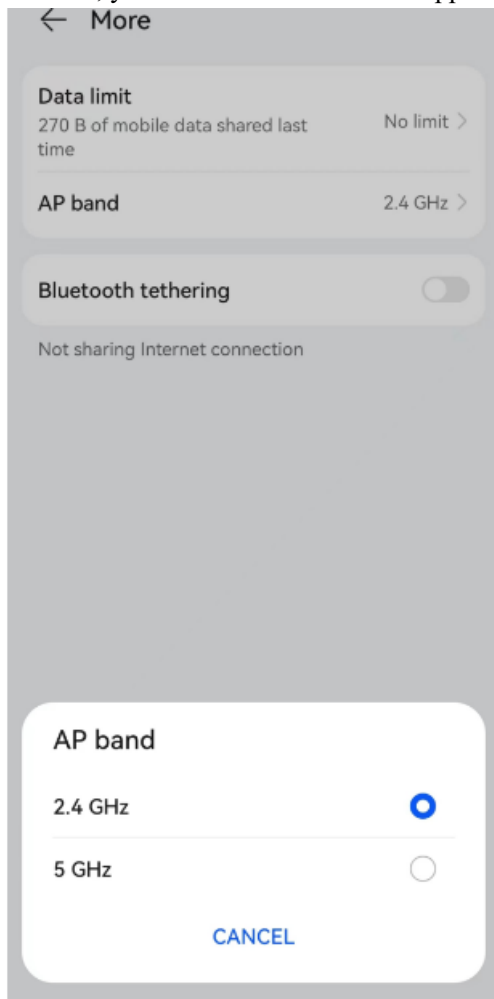

Note: When you do not need WLAN and want to reapply the WIFI function. You need to turn off your connected WLAN, and then wait for the small light above the iot card to blink in order to detect the WIFI of the IOT card, and then use the WIFI APP to turn off the WLAN function afterwards.